

## NH ATLANTIC DEN HAAG

### LOCATION

hotel is located nearby the dynamic centre of The Hague and the well-known seaside resort Scheveningen. NH Atlantic Den Haag is easily reachable, by car as well as by public transportation.

Station Den Haag CS **10 km**

Schiphol Airport **55 km**

Bus stop **0,1 km**



### CONTACT

Deltaplein, 2554 EJ

Den Haag, The Netherlands

Information: +31 (0)70 448 2482

Reservations: +31 (0)20 70 18 042

nhatlaticdenhaag@nh-hotels.com

### CONTACT FOR MEETINGS

nhmeetingsales.nl@nh-hotels.com

+31 (0)85 902 23 30

**nh-hotels.com**



own parking



free wi-fi



accessible



celebrations



gym



meetings



pets allowed



pool



### 152 ROOMS

- 78 standard rooms
- 18 superior rooms
- 36 superior rooms with view
- 20 suites
- 1 superior room adapted for the disabled

### ROOM FACILITIES

- free wireless internet access
- direct dial telephone
- mini bar
- toiletry kit
- hairdryer
- wake up service
- room safety deposit box
- room service

### FOOD & DRINKS

- restaurant Gusto
- bar Sabor
- buffet breakfast
- 'early birds' breakfast

### HOTEL FACILITIES

- business centre
- facilities for the disabled
- dry cleaning service
- parking (paid)
- free newspaper
- swimming pool
- sauna/Turkish steambath
- fitness

### MEETINGS & EVENTS

- 20 meeting rooms
- capacity for up to 300 people
- teambuilding activities
- suitable for all kinds of events

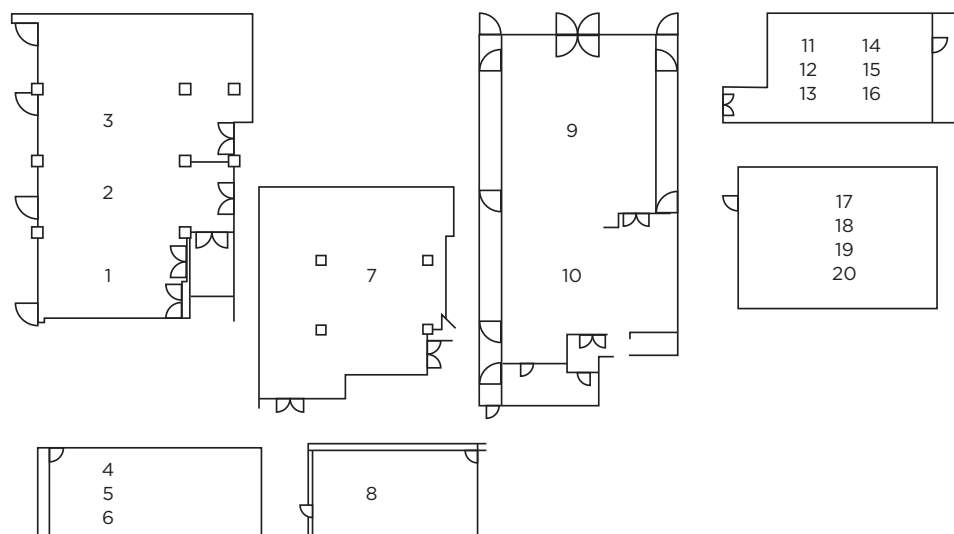

- 1 Rioja 1
- 2 Rioja 2
- 3 Rioja 3
- 4 Aragón
- 5 Badagoz
- 6 Taragona
- 7 La Palma
- 8 Rueda
- 9 Jerez 1
- 10 Jerez 2
- 11 211 - Valdepénas
- 12 311 - La Mancha
- 13 411 - Penedés
- 14 511 - Monterrei
- 15 611 - Arribes
- 16 711 - Ribeiro
- 17 200 - Priorato
- 18 300 - Ribero de Duero
- 19 400 - Somontano
- 20 500 - Toro

**FUNCTION ROOMS AND THEIR CAPACITIES**

| MEETING ROOM NAME | AREA           |      | board room | carré | u-shape | theatre | cabaret | classroom | cocktail | dinner | DAYLIGHT |
|-------------------|----------------|------|------------|-------|---------|---------|---------|-----------|----------|--------|----------|
|                   | M <sup>2</sup> | FEET |            |       |         |         |         |           |          |        |          |
| Rioja 1           | 67             | 721  | 22         | 32    | 25      | 50      | 32      | 28        | 50       | 22     | Yes      |
| Rioja 2           | 65             | 700  | 22         | 22    | 20      | 50      | 32      | 24        | 50       | 22     | Yes      |
| Rioja 3           | 140            | 1507 | 30         | 42    | 38      | 100     | 56      | 40        | 100      | 30     | Yes      |
| Rioja 1 + 2       | 132            | 1421 | 22         | 38    | 40      | 120     | 56      | 40        | 75       | 50     | Yes      |
| Rioja 2 + 3       | 205            | 2207 | 24         | 48    | 42      | 160     | 72      | 48        | 120      | 80     | Yes      |
| Rioja 1 + 2 + 3   | 272            | 2928 | -          | 82    | 62      | 250     | 130     | 90        | 200      | 150    | Yes      |
| Aragón            | 24             | 258  | 12         | -     | -       | 20      | -       | -         | -        | 12     | Yes      |
| Badagoz           | 22             | 237  | 12         | -     | -       | 15      | -       | -         | -        | 12     | Yes      |
| Taragona          | 30             | 322  | 14         | -     | -       | 25      | -       | -         | -        | 14     | Yes      |
| La Palma          | 160            | 1722 | -          | 20    | 26      | 100     | 50      | 50        | 150      | 100    | Yes      |
| Rueda             | 30             | 322  | 12         | -     | -       | 20      | -       | -         | -        | 12     | Yes      |
| Jerez 1           | 220            | 2368 | 30         | 60    | 55      | 225     | 96      | 64        | 200      | 150    | No       |
| Jerez 2           | 85             | 915  | 22         | 32    | 30      | 50      | 32      | 26        | 50       | 30     | No       |
| Jerez 1 + 2       | 305            | 3283 | -          | -     | -       | 300     | 130     | 126       | 250      | 200    | No       |
| Valdepénas        | 38             | 409  | 14         | -     | 15      | 25      | -       | -         | -        | 14     | Yes      |
| La Mancha         | 38             | 409  | 14         | -     | 15      | 25      | -       | -         | -        | 14     | Yes      |
| Penedés           | 38             | 409  | 14         | -     | 15      | 25      | -       | -         | -        | 14     | Yes      |
| Monterrei         | 38             | 409  | 14         | -     | 15      | 25      | -       | -         | -        | 14     | Yes      |
| Arribes           | 38             | 409  | 14         | -     | 15      | 25      | -       | -         | -        | 14     | Yes      |
| Ribeiro           | 38             | 409  | 14         | -     | 15      | 25      | -       | -         | -        | 14     | Yes      |
| Priorato          | 30             | 322  | 6          | -     | -       | -       | -       | -         | -        | 6      | Yes      |
| Ribero de Duero   | 34             | 366  | 14         | -     | 13      | 20      | -       | -         | -        | 14     | Yes      |
| Somontano         | 34             | 366  | 14         | -     | 13      | 20      | -       | -         | -        | 14     | Yes      |
| Toro              | 34             | 366  | 12         | -     | -       | -       | -       | -         | -        | 12     | Yes      |

**CONTACT FOR MEETINGS**

nhmeetingsales.nl@nh-hotels.com

+31 (0)85 902 23 30

**nh-hotels.com**